

TO LET Retail Unit

1,317 sq ft (122.4 sqm)

A1 planning consent

Orbit
Developments

Unit 2, Grove Chambers, Grove Street, Wilmslow SK9 1DT

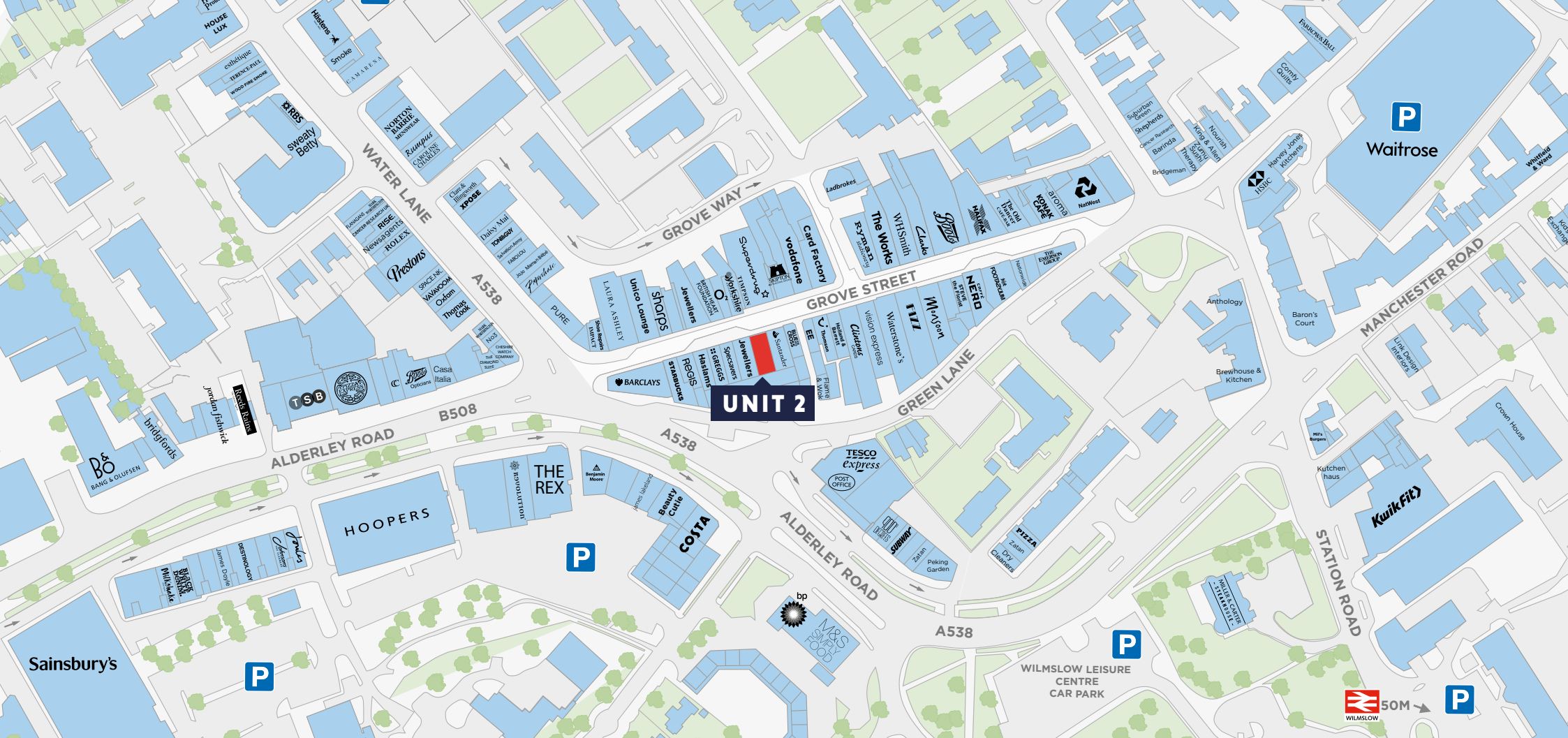

The vibrant Cheshire town of Wilmslow is renowned for its wealth of stylish shops, cafés, trendy bars and quality restaurants. The area, which lies between Handforth and the affluent suburbs of Alderley Edge, Knutsford and Prestbury is known for its up market lifestyle and its many rich and famous residents.

Situated in the south Manchester commuter belt Wilmslow has a population of approximately 160,000 within 15 minutes of the town centre and benefits from easy access to the M56, M60 and M6 motorways as well as its proximity to Manchester airport. Wilmslow Railway Station is just a five minute walk from Grove Chambers, and provides a regular service to local villages as well as commuter services to Manchester Piccadilly.

Wilmslow shoppers have a fantastic choice of luxury brands situated alongside the usual popular high street fascias. The main shopping cluster lies within the triangle formed by Grove Street, Water Lane and Alderley Road, and Grove Chambers are well positioned in a central location. The unit benefits from a significant amount of footfall as shoppers traverse the pedestrianised area on Grove Street where the majority of shops are located.

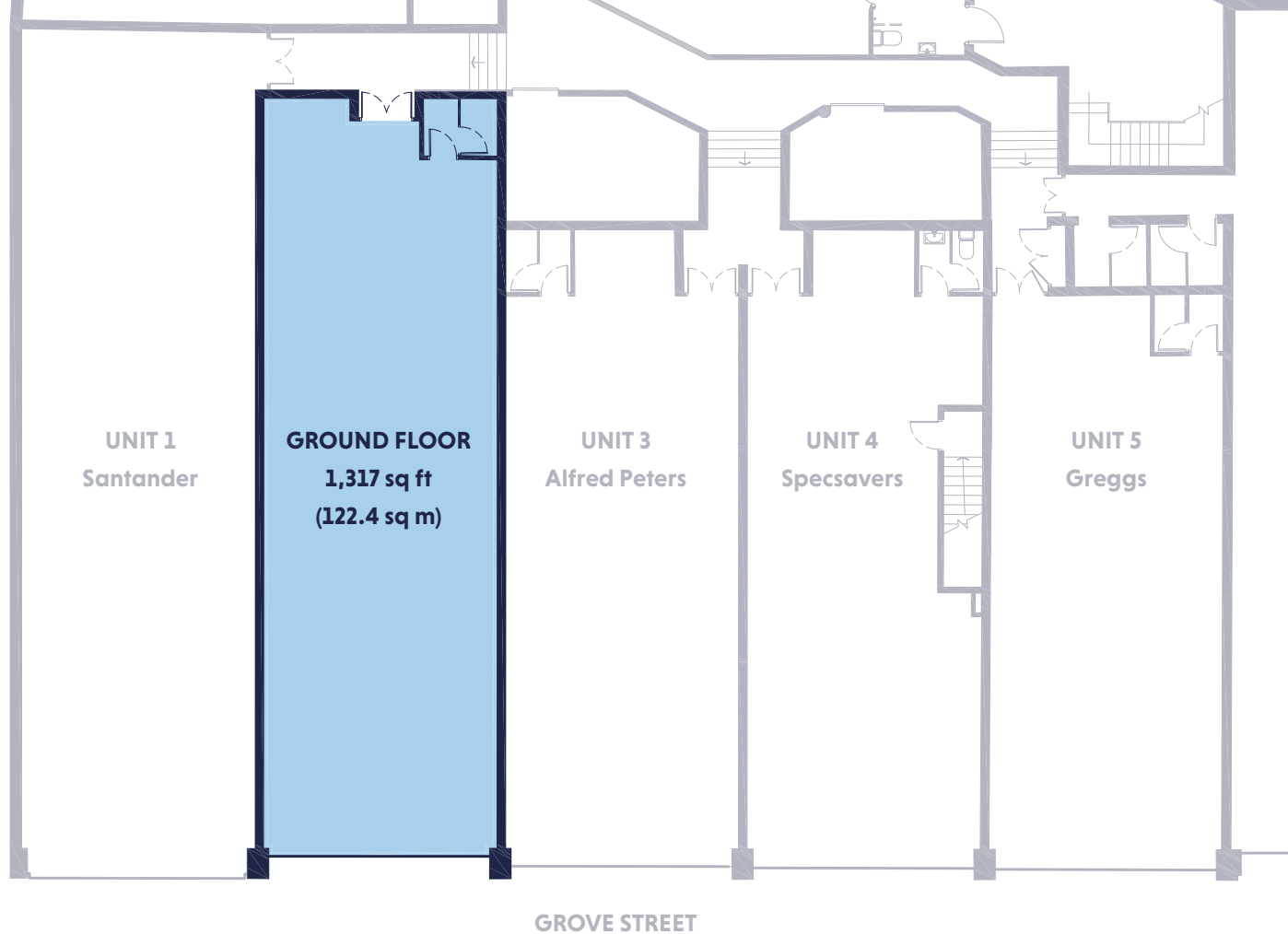

THE UNIT

The unit has planning consent for A1 retail and offers a high specification throughout.

- Ideally located close to Wilmslow pedestrianised shopping centre
- Ample local parking
- Surrounded by a fantastic range of high street brands and a variety of niche boutiques
- Large glazed shopfront

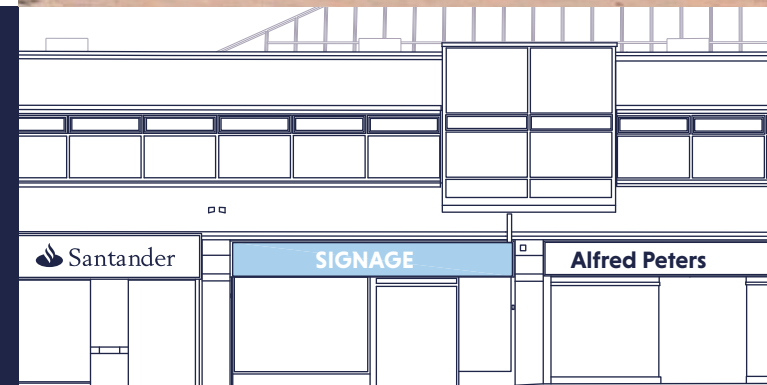

Front elevation



DRIVE TIMES:

Alderley Edge	7 mins
Handforth	7 mins
Prestbury	14 mins
Bramhall	14 mins
Macclesfield	20 mins
Poynton	21 mins
Knutsford	21 mins
Stockport	22 mins
Manchester	33 mins

Orbit Developments

01625 588200

www.orbit-developments.co.uk

DISCLAIMER: These particulars are believed to be correct at time of going to press, but the developer reserves the right to change the scheme in the future. However, the vendors/ lessors and agents of this property give notice that: (1) These particulars are intended as a general outline only, for the guidance of prospective purchasers or tenants, and do not constitute the whole or any part of an offer or contract. (2) They cannot guarantee the accuracy of any description, dimension or other details contained in these particulars and prospective purchasers or tenants should not rely on them as statements of fact or representation, but must satisfy themselves as to the accuracy of such details. (3) No employee of the agents has any authority to make or give any representation or warranty, or enter into any contract whatsoever in relation to the property. (4) Prices and rents quoted in these particulars may be subject to VAT in addition. August 2019. Bella Design & Marketing www.belladesign.co.uk

