

To Let - Unit 2 Retail / F&B Unit

Brand new terrace of units adjoining a new Aldi Foodstore and a McDonalds Drive Thru'



Keighley

Coney Lane, BD21 5JA

Units from 1,300 sq ft (120.77 sq m)

Rent: £30 per sq ft

Location & Description:

- The subject property occupies an extremely prominent position off Coney Lane, Keighley bordering East Parade and Gresley Road on the fringe of the town centre.
- Bradford city centre lies 10 miles South and Skipton 8 miles North West.
- Unit 1 adjacent (3,700 sq ft) – under offer to a national restaurant operator, to open Q2 2026.
- Suitable for retail or catering offer – with dual frontages facing roadside and the car park.
- There is a shared refuse area to one side and 40 on site car parking spaces – not designated – within the shared Aldi car park.

Demise:

Unit 1 3,700 sq ft (343.74 sq m) – **UNDER OFFER**

Unit 2 1,300 sq ft (120.77 sq m)

Rent:

Rent quoted is £30 per sq ft

Lease:

Available by way of a new 10 year full repairing and insuring lease subject to an open market rent review at the end of Year 5.

Service Charge:

A service charge will be levied to cover the cost of external repairs to the common areas this has been estimated at £3 per sq.ft.

EPC:

A valid EPC certificate is not available as the units are not fitted out but the tenants must supply one on completion of any shop fit.

Legal and professional fees:

Each party to pay their own.

Rating Assessment:

The business rates are to be assessed by the Valuation Office Agency and applicants should make their own enquiries.

VAT:

VAT may be applicable and if so will be charged at the prevailing rate.

Date Prepared:

November 2025

MONEY LAUNDERING REGULATIONS In accordance with the Anti Money Laundering Regulations the Purchaser/Tenant will be required to provide two forms of identification and proof of the source of income.

Contact Us:**Grant Owens**

07808 646576
grant@barkerproudlove.co.uk

Steve Henderson

07870 999618
steveh@barkerproudlove.co.uk

Joint Agent:**Lamb & Swift**

01204 522275

Nick Swift

nswift@lambandswift.com

Lois Sutton

lsutton@lambandswift.com

Kieran Sutton

ksutton@lambandswift.com

IMPORTANT NOTICE: Barker Proudlove gives notice to anyone who may read these particulars as follows: 1. These particulars are prepared for guidance only of prospective purchasers. They are intended to give a fair overall description of the property, but are not intended to constitute part of an offer or contract. 2. Any information contained herein (whether in the text, plans or photography) is given in good faith but should not be relied upon as being a statement or representation of fact. 3. Nothing in these particulars shall be deemed to be a statement that the property is in good condition or otherwise nor that any services or facilities are in good working order. 4. The photographs appearing in this brochure show only certain aspects of the property at the time when the photographs were taken. Certain aspects may have changed since the photographs were taken and it should not be assumed that the property remains precisely as displayed in the photographs. Furthermore no assumptions should be made in respect of parts of the property which are not shown in the photographs. 5. Any areas, measurements or distances referred to herein are approximate only. 6. Where there is reference in these particulars to the fact alterations have been carried out or that a particular use is made of any part of the property this is not intended to be a statement that any necessary planning, building regulations or other consents have been obtained and these matters must be verified by any intending purchaser. 7. Descriptions of a property are inevitably subjective and the descriptions contained herein are used in good faith as an opinion and not by way of statement of fact.

Location Plan

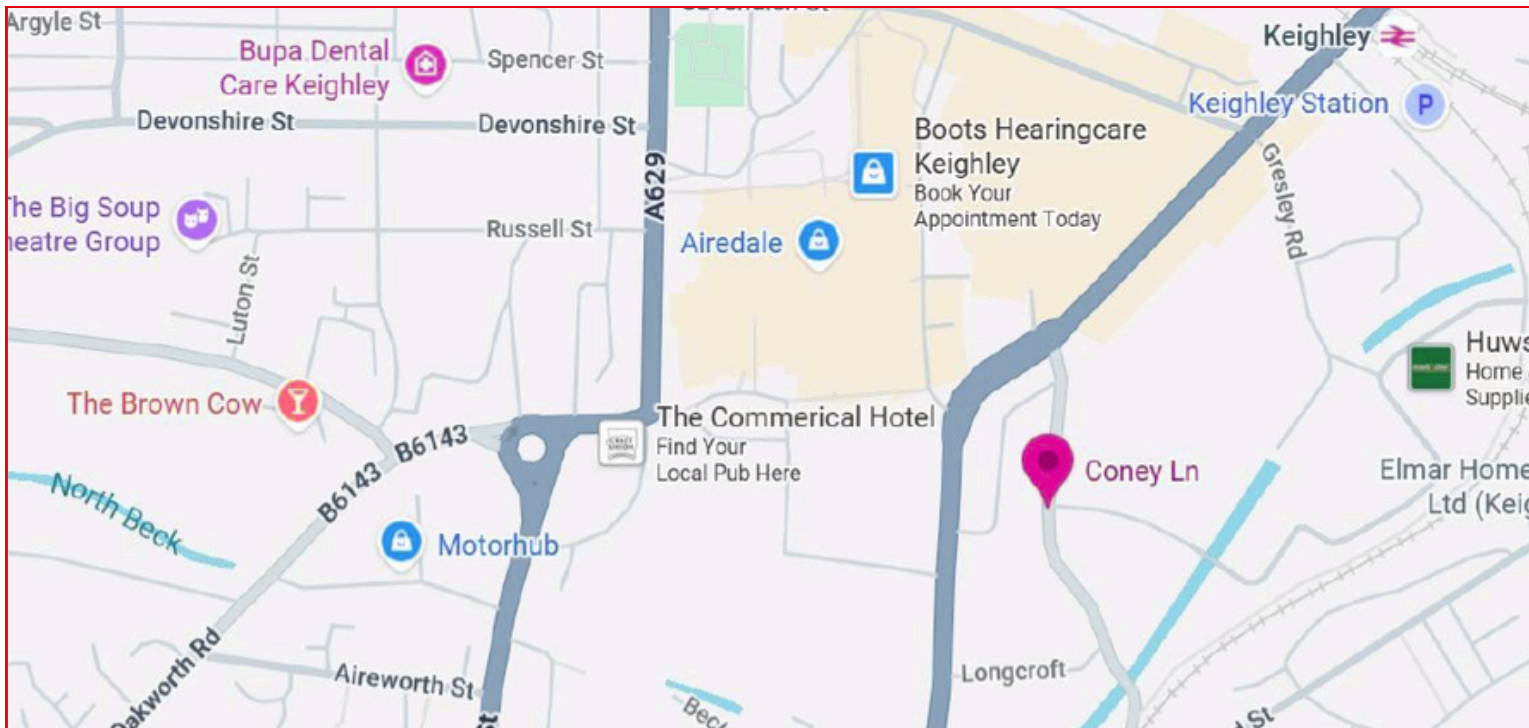
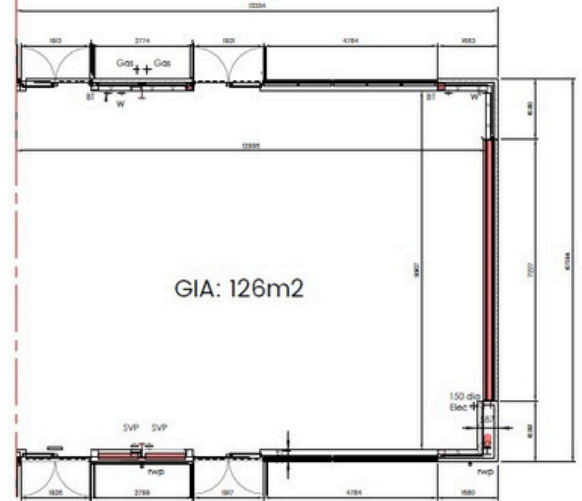

IMPORTANT NOTICE: Barker Proudlove gives notice to anyone who may read these particulars as follows: 1. These particulars are prepared for guidance only of prospective purchasers. They are intended to give a fair overall description of the property, but are not intended to constitute part of an offer or contract. 2. Any information contained herein (whether in the text, plans or photography) is given in good faith but should not be relied upon as being a statement or representation of fact. 3. Nothing in these particulars shall be deemed to be a statement that the property is in good condition or otherwise nor that any services or facilities are in good working order. 4. The photographs appearing in this brochure show only certain aspects of the property at the time when the photographs were taken. Certain aspects may have changed since the photographs were taken and it should not be assumed that the property remains precisely as displayed in the photographs. Furthermore no assumptions should be made in respect of parts of the property which are not shown in the photographs. 5. Any areas, measurements or distances referred to herein are approximate only. 6. Where there is reference in these particulars to the fact alterations have been carried out or that a particular use is made of any part of the property this is not intended to be a statement that any necessary planning, building regulations or other consents have been obtained and these matters must be verified by any intending purchaser. 7. Descriptions of a property are inevitably subjective and the descriptions contained herein are used in good faith as an opinion and not by way of statement of fact.



IMPORTANT NOTICE: Barker Proudlove gives notice to anyone who may read these particulars as follows: 1. These particulars are prepared for guidance only of prospective purchasers. They are intended to give a fair overall description of the property, but are not intended to constitute part of an offer or contract. 2. Any information contained herein (whether in the text, plans or photography) is given in good faith but should not be relied upon as being a statement or representation of fact. 3. Nothing in these particulars shall be deemed to be a statement that the property is in good condition or otherwise nor that any services or facilities are in good working order. 4. The photographs appearing in this brochure show only certain aspects of the property at the time when the photographs were taken. Certain aspects may have changed since the photographs were taken and it should not be assumed that the property remains precisely as displayed in the photographs. Furthermore no assumptions should be made in respect of parts of the property which are not shown in the photographs. 5. Any areas, measurements or distances referred to herein are approximate only. 6. Where there is reference in these particulars to the fact alterations have been carried out or that a particular use is made of any part of the property this is not intended to be a statement that any necessary planning, building regulations or other consents have been obtained and these matters must be verified by any intending purchaser. 7. Descriptions of a property are inevitably subjective and the descriptions contained herein are used in good faith as an opinion and not by way of statement of fact.