

COMING SOON

PRIME RETAIL OPPORTUNITY

Six new ground floor retail units

PILGRIM'S QUARTER

Newcastle upon Tyne



PILGRIM'S QUARTER

Newcastle upon Tyne



New Bridge Street West Elevation



The Location

Pilgrim's Quarter is located in the heart of Newcastle City Centre on Pilgrim Street at its junction with Northumberland Street and Blackett Street.

The development will comprise of 468,500 sq ft of offices let to HMRC.

Planned works of re-surfacing and street furniture will enhance the location and provide an attractive public realm on Completion in 2025.

**PILGRIM'S
QUARTER**
Newcastle upon Tyne



The Opportunity

The development will include six new retail units located at ground floor which will be of interest to Financial Services, Retail and 'lite' Food and Beverage type uses.

Being within the prime retail core diagonally opposite the iconic Monument Mall and within the newest and largest development in the City Centre, the opportunity to secure representation is an exciting one.

**PILGRIM'S
QUARTER**
Newcastle upon Tyne

Accommodation Ground Floor

**PILGRIM'S
QUARTER**
Newcastle upon Tyne

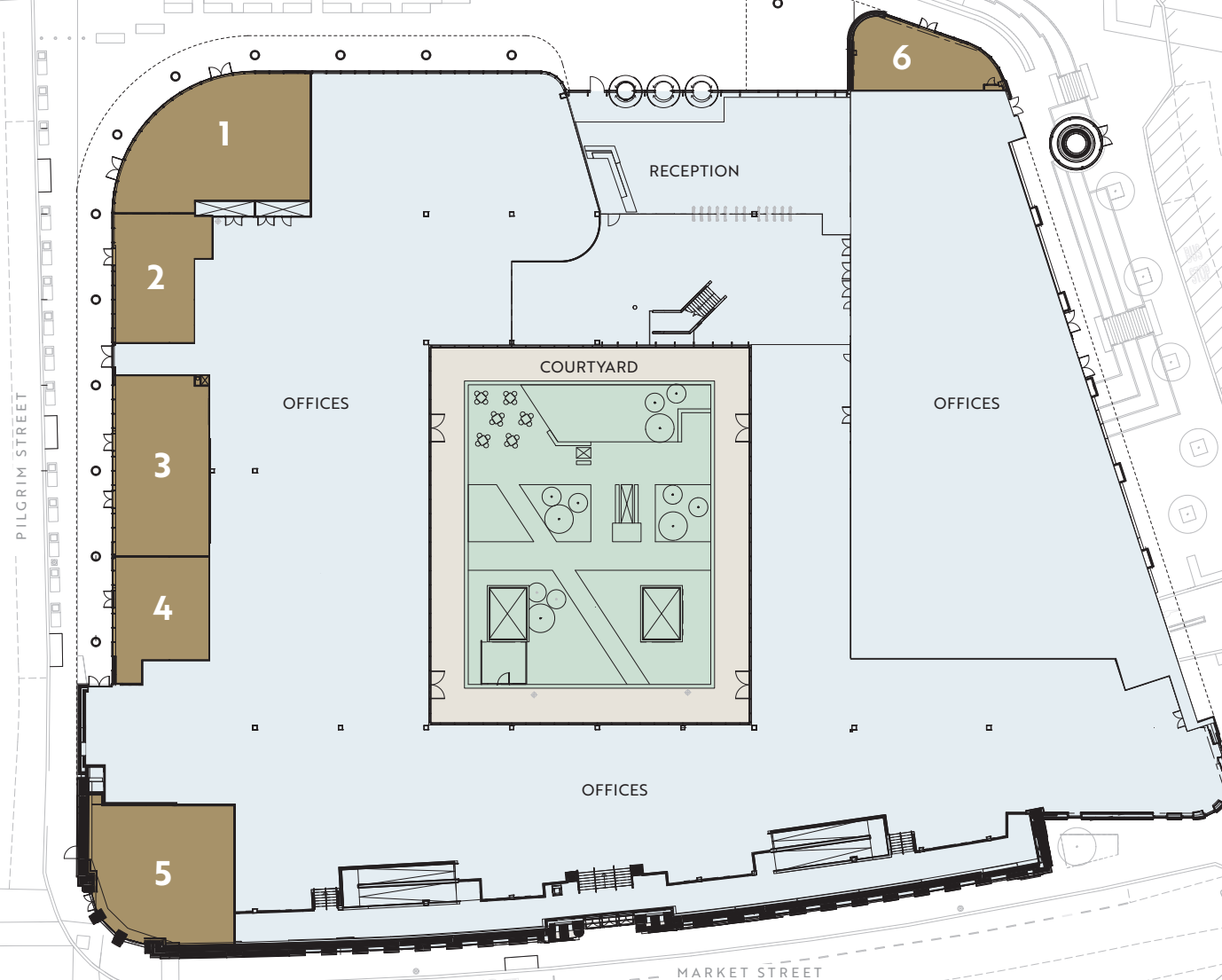

Accommodation and Terms

The units are available by way of a new effective full
• Repairing and Insuring lease for a term to be agreed
incorporating 5 yearly rent reviews.

Floor areas (GIA) and quoting rents are as follows:

RETAIL UNITS	SQ FT	SQM	RENT
Unit 1	2,174	202	Under Offer
Unit 2	1,227	114	£65,000pa
Unit 3	2,067	192	£110,000pa
Unit 4	1,345	125	£70,000pa
Unit 5	2,583	240	£95,000pa
Unit 6	990	92	£32,500pa
TOTAL RETAIL AREA	10,398	966	

Service Charge

Annual Service Charge TBC but estimated at £3.00 sq ft.

Business Rates

The units have not yet been assessed for Rates purposes.

PILGRIM'S QUARTER

Newcastle upon Tyne

Surrounding Activity

PEDESTRIAN IMPROVEMENTS

Newcastle City Council have commenced public realm improvements on Northumberland Street and Pilgrim Street with works due to complete in October 2025.

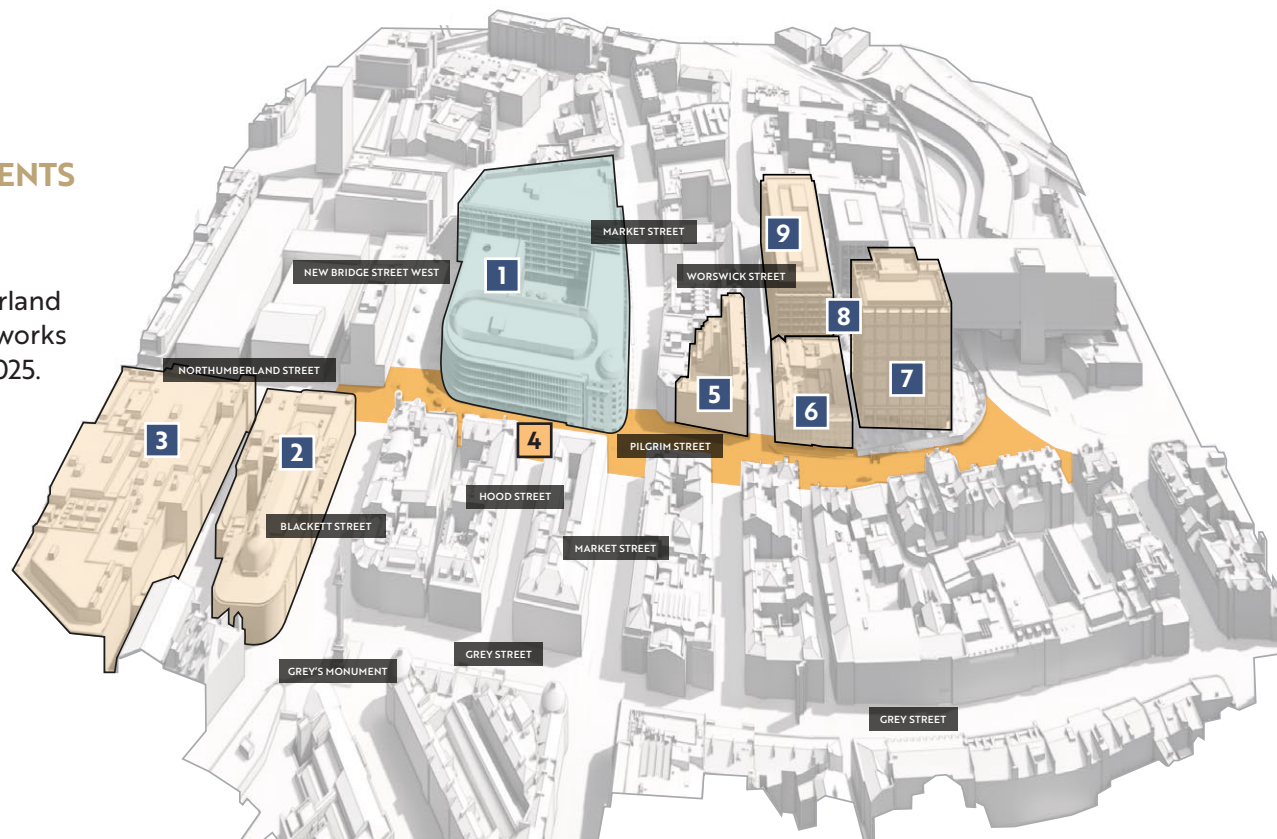

1 PILGRIM'S QUARTER



2 MONUMENT MALL

Provides over 135,000 sq ft of prime modern retail and leisure accommodation.

3 FENWICK

Flagship department store with planned multi-million pound investment / renovation programme.

4 PILGRIM STREET PUBLIC REALM

Enhancements to Pilgrim Street funded by LEP.

5 BOUTIQUE HOTEL

90 bed 5* Gotham Hotel by Bespoke with ground floor café, bar and restaurant in the refurbished Grade II Listed building.

6 WORSWICK CHAMBERS

New food and leisure operation extending to 45,500 sq ft within fully refurbished Grade II listed building.

7 BANK HOUSE

A new 120,120 sq ft gateway office to the city at the southern end of Pilgrim Street.

8 PILGRIM PLACE

New public square at the heart of the southern block.

9 1-2 PILGRIM PLACE

Two Grade A office buildings with over 250,000 sq ft accommodation.



Bank House



Worswick Chambers



Boutique Hotel



Monument Mall

PILGRIM'S QUARTER

Newcastle upon Tyne

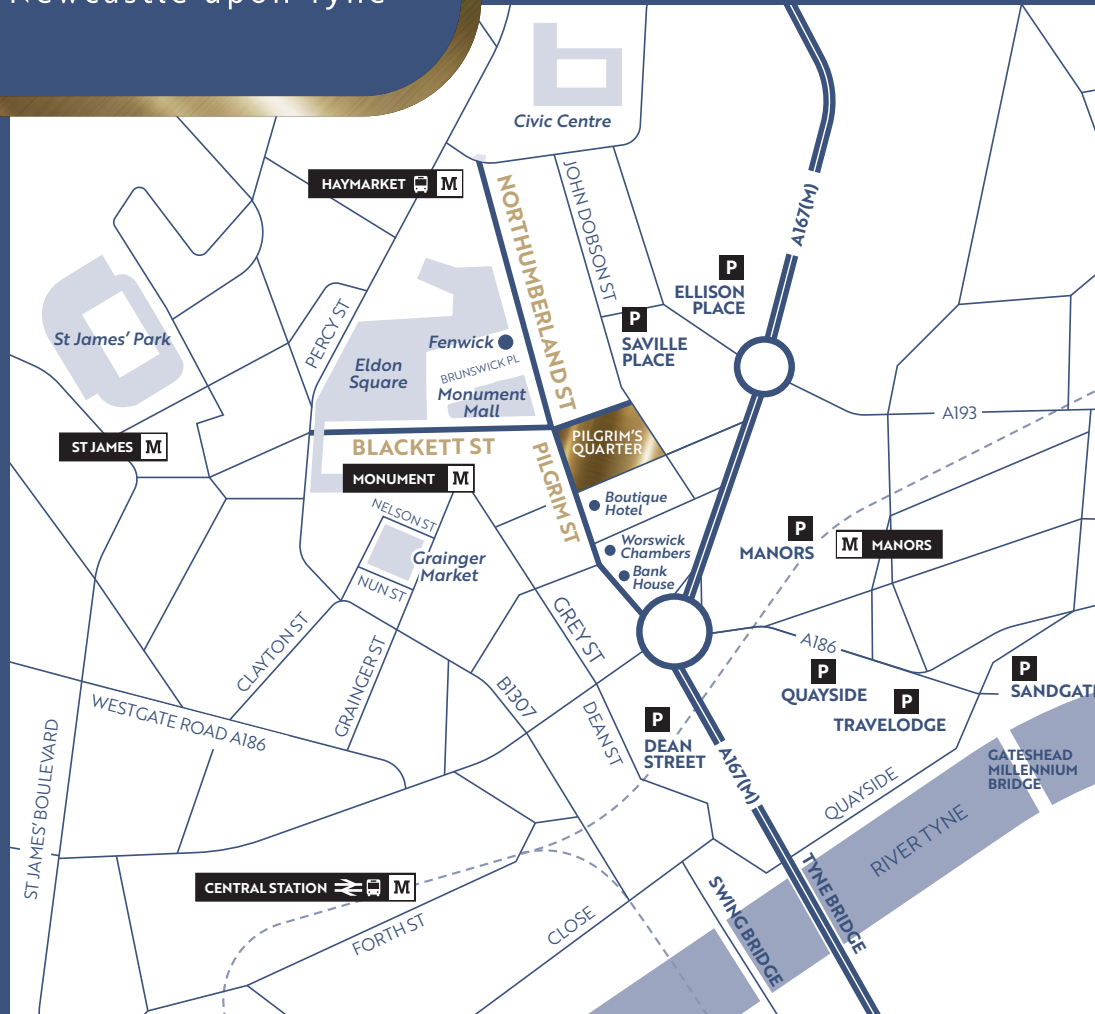

**CONTACT JOINT AGENTS
TO DISCUSS THE OPPORTUNITIES
IN FURTHER DETAIL**

@retail
ANGUS : THURLBECK PROPERTY CONSULTANTS

Barker Proudlove

IAN ANGUS

T: 07960 466211

E: iana@atretail.co.uk

STEVE HENDERSON

T: 07870 999618

E: steveh@barkerproudlove.co.uk

IMPORTANT NOTICE: Barker Proudlove and ATF Retail Limited give notice to anyone who may read these particulars as follows: 1. These particulars are prepared for guidance only of prospective purchasers. They are intended to give a fair overall description of the property, but are not intended to constitute part of an offer or contract. 2. Any information contained herein (whether in the text, plans or photography) is given in good faith but should not be relied upon as being a statement or representation of fact. 3. Nothing in these particulars shall be deemed to be a statement that the property is in good condition or otherwise nor that any services or facilities are in good working order. 4. The photographs appearing in this brochure show only certain aspects of the property at the time when the photographs were taken. Certain aspects may have changed since the photographs were taken. Furthermore no assumptions should be made in respect of parts of the property which are not shown in the photographs. 5. Any areas, measurements or distances referred to herein are approximate only. 6. Where there is reference in these particulars to the fact alterations have been carried out or that a particular use is made of any part of the property this is not intended to be a statement that any necessary planning, building regulations or other consents have been obtained and these matters must be verified by any intending purchaser. 7. Descriptions of a property are inevitably subjective and the descriptions contained herein are used in good faith as an opinion and not by way of statement of fact. August 2024.