

# To Let



## Newcastle-Upon-Tyne

8-16 Nun Street, NE1 5AQ

Ground Floor: 11,334 sq ft (1,053 sq m)

Accommodation can be split for smaller unit requirements

Rent on Application

Former Wilko Store

---

**Location & Description:**

- Fronting both Nun Street and Newgate Street, the premises is located in a central city centre location, being a short walk from Newcastle Central Train Station, and situated in close proximity to Eldon Square Shopping Centre and The Gate Leisure scheme within the heart of the city's retail and leisure pitch.
  - Other nearby landmarks include The Grainger Market, Bigg Market and Grey's Monument.
  - The ground floor accommodation is available on a new lease, with the upper floors to be converted into future residential use, subject to consents.
  - The building offers two shopper entrances off both Nun Street and Newgate Street.
  - Subject to consents, the accommodation has the potential to be split into smaller units – see layout plan below.
- 

**Demise:**

Ground Floor Sales 11,334 sq ft (1,053 sq m)  
Potential to split into small units.

**Rent:**

Available upon request.

**Lease:**

Subject to formal vacant possession, a new lease is available for a term of years to be agreed.

**EPC:**

Available upon request.

**Legal and Professional Fees:**

Each party to bear their own costs.

**Planning Permission:**

The building is located within the Newcastle Central Conservation Area and the Nun Street elevation is subject to a Grade II listing.

**Rating Assessment:**

The accommodation will be subject to a VOA assessment following the proposed split works.

**Date Prepared:**

Updated April 2025

**Contact Us:**

**Mark Proudlove**

07808 479310

mark@barkerproudlove.co.uk

**John Peart**

07785 741198

johnp@barkerproudlove.co.uk

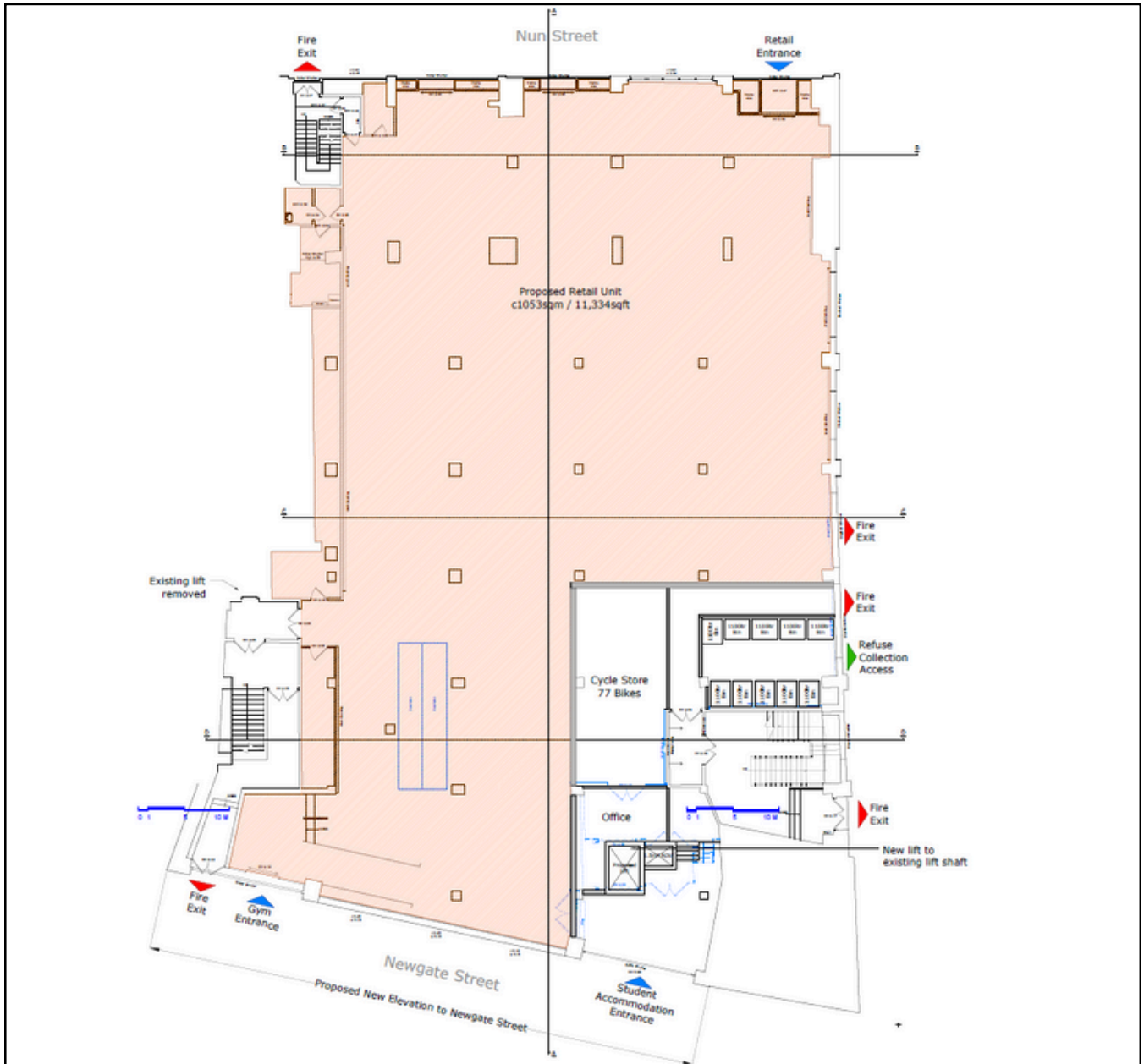

## Ground Floor Layout Plan for a Single Occupier

IMPORTANT NOTICE: Barker Proudlove gives notice to anyone who may read these particulars as follows: 1. These particulars are prepared for guidance only of prospective purchasers. They are intended to give a fair overall description of the property, but are not intended to constitute part of an offer or contract. 2. Any information contained herein (whether in the text, plans or photography) is given in good faith but should not be relied upon as being a statement or representation of fact. 3. Nothing in these particulars shall be deemed to be a statement that the property is in good condition or otherwise nor that any services or facilities are in good working order. 4. The photographs appearing in this brochure show only certain aspects of the property at the time when the photographs were taken. Certain aspects may have changed since the photographs were taken and it should not be assumed that the property remains precisely as displayed in the photographs. Furthermore no assumptions should be made in respect of parts of the property which are not shown in the photographs. 5. Any areas, measurements or distances referred to herein are approximate only. 6. Where there is reference in these particulars to the fact alterations have been carried out or that a particular use is made of any part of the property this is not intended to be a statement that any necessary planning, building regulations or other consents have been obtained and these matters must be verified by any intending purchaser. 7. Descriptions of a property are inevitably subjective and the descriptions contained herein are used in good faith as an opinion and not by way of statement of fact.



## Ground Floor Layout Plan Showing Potential for Smaller Units

IMPORTANT NOTICE: Barker Proudlove gives notice to anyone who may read these particulars as follows: 1. These particulars are prepared for guidance only of prospective purchasers. They are intended to give a fair overall description of the property, but are not intended to constitute part of an offer or contract. 2. Any information contained herein (whether in the text, plans or photography) is given in good faith but should not be relied upon as being a statement or representation of fact. 3. Nothing in these particulars shall be deemed to be a statement that the property is in good condition or otherwise nor that any services or facilities are in good working order. 4. The photographs appearing in this brochure show only certain aspects of the property at the time when the photographs were taken. Certain aspects may have changed since the photographs were taken and it should not be assumed that the property remains precisely as displayed in the photographs. Furthermore no assumptions should be made in respect of parts of the property which are not shown in the photographs. 5. Any areas, measurements or distances referred to herein are approximate only. 6. Where there is reference in these particulars to the fact alterations have been carried out or that a particular use is made of any part of the property this is not intended to be a statement that any necessary planning, building regulations or other consents have been obtained and these matters must be verified by any intending purchaser. 7. Descriptions of a property are inevitably subjective and the descriptions contained herein are used in good faith as an opinion and not by way of statement of fact.

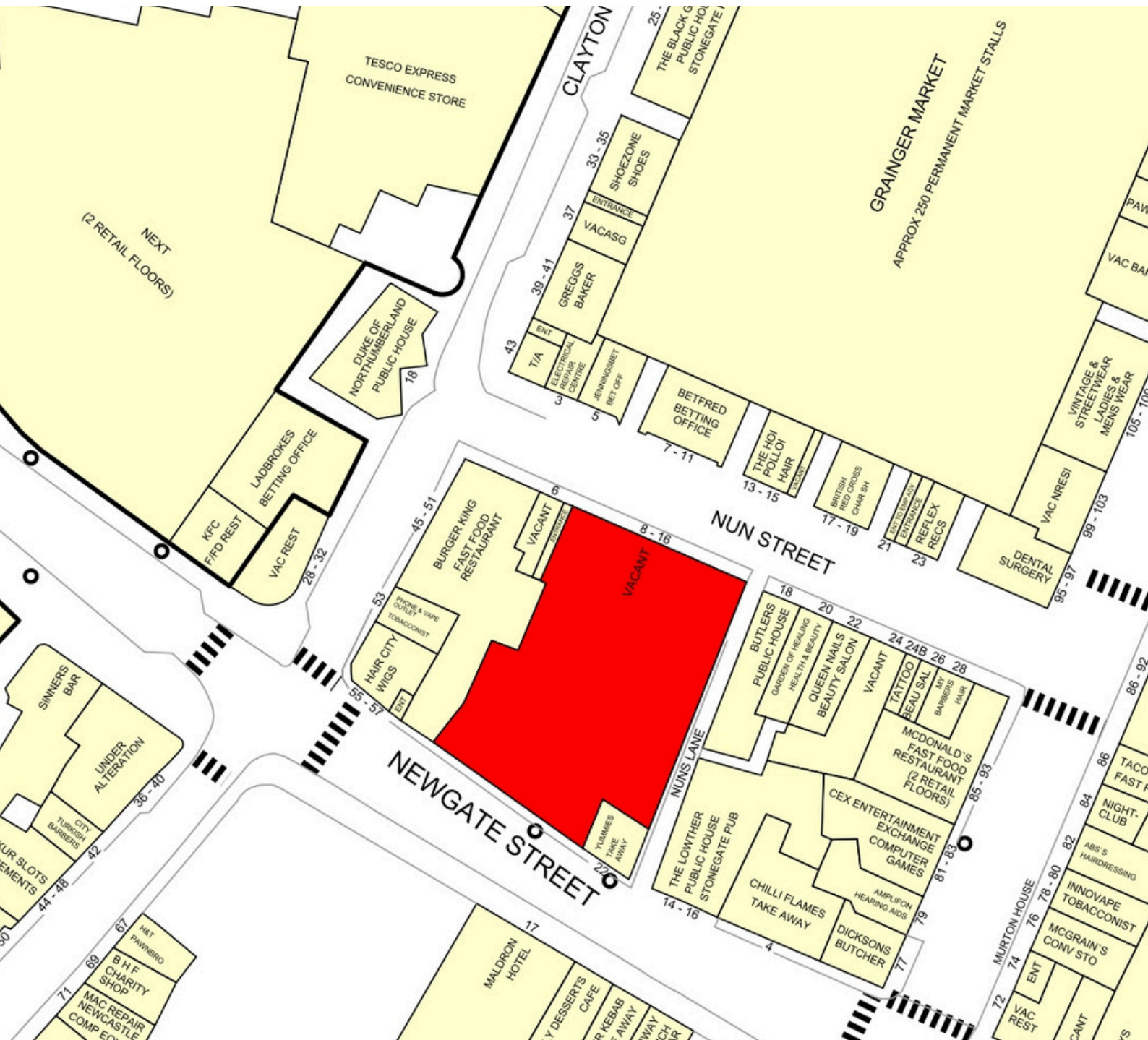

IMPORTANT NOTICE: Barker Proudlove gives notice to anyone who may read these particulars as follows: 1. These particulars are prepared for guidance only of prospective purchasers. They are intended to give a fair overall description of the property, but are not intended to constitute part of an offer or contract. 2. Any information contained herein (whether in the text, plans or photography) is given in good faith but should not be relied upon as being a statement or representation of fact. 3. Nothing in these particulars shall be deemed to be a statement that the property is in good condition or otherwise nor that any services or facilities are in good working order. 4. The photographs appearing in this brochure show only certain aspects of the property at the time when the photographs were taken. Certain aspects may have changed since the photographs were taken and it should not be assumed that the property remains precisely as displayed in the photographs. Furthermore no assumptions should be made in respect of parts of the property which are not shown in the photographs. 5. Any areas, measurements or distances referred to herein are approximate only. 6. Where there is reference in these particulars to the fact alterations have been carried out or that a particular use is made of any part of the property this is not intended to be a statement that any necessary planning, building regulations or other consents have been obtained and these matters must be verified by any intending purchaser. 7. Descriptions of a property are inevitably subjective and the descriptions contained herein are used in good faith as an opinion and not by way of statement of fact.