

PROMINENTLY LOCATED MSU

SUITABLE FOR RETAIL/LEISURE/RESTAURANT/FAMILY ENTERTAINMENT USES (Subject To Consents)

VL
VICAR LANE
SHOPPING CENTRE



TO LET 29,885 SQ.FT. (2,776 SQ M)

28 STEEPLEGATE, CHESTERFIELD • S40 1PY



NEW LOOK

RIVER ISLAND



Iceland



DEICHMANN



PROMINENTLY LOCATED MSU
SUITABLE FOR RETAIL/LEISURE/
RESTAURANT/FAMILY ENTERTAINMENT
USES SUBJECT TO CONSENTS

LOCATION

Chesterfield is a thriving historic market town which is popular with shoppers and tourists alike. The town offers a superb blend of shops, restaurants and cafés and one of the largest open air markets in England. The region also boasts a wide range of leisure destinations, including the Peak District National Parks and Chatsworth House.

With a population in excess of 104,000 and a loyal catchment, Chesterfield is a strong retail destination.

Chesterfield is an increasingly popular tourist destination with approximately 3.31M visitors per annum generating an average annual shopping spend of £31.52M.

Vicar Lane is located in the heart of Chesterfield town centre, positioned between the famous Crooked Spire and the markets. The uncovered shopping centre is the focus for prime retailing and includes H&M, River Island, New Look, Deichmann and JD Sports.

The scheme includes one of the town's principal car parks providing 390 spaces.

The subject premises offer a prominent corner location, with nearby retailers including Waterstones, Iceland and Superdrug.



PROMINENTLY LOCATED MSU
SUITABLE FOR RETAIL/LEISURE/
RESTAURANT/FAMILY ENTERTAINMENT
USES SUBJECT TO CONSENTS

ACCOMMODATION

The property is arranged over ground and first floors. Indicative split options can be seen below. Other split options can be considered to suit specific requirements.



GROUND FLOOR: 12,940 SQ FT

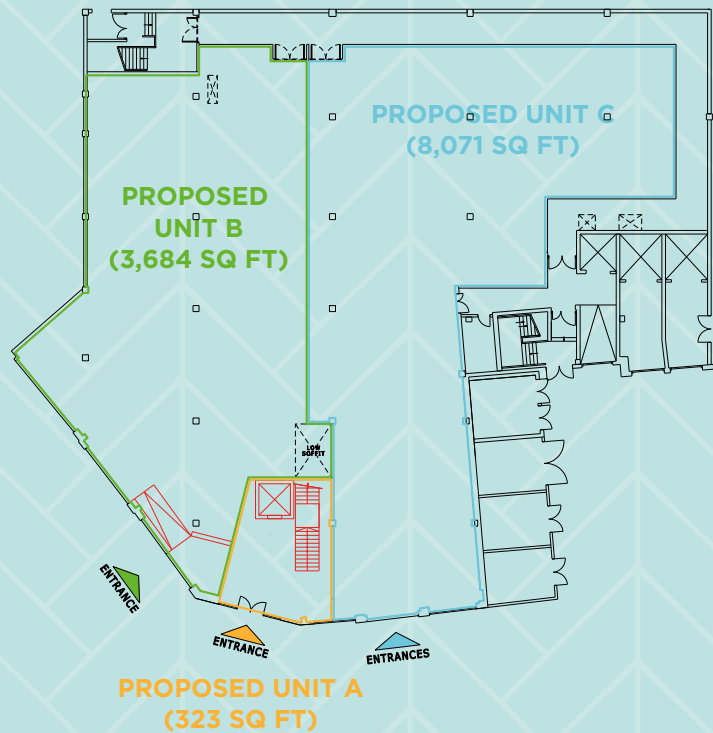

FIRST FLOOR: 16,945 SQ FT



VL

VICAR LANE

SHOPPING CENTRE



SEE CHESTERFIELD - RAVENSIDE RETAIL PARK PLAN



PROMINENTLY LOCATED MSU
SUITABLE FOR RETAIL/LEISURE/
RESTAURANT/FAMILY ENTERTAINMENT
USES SUBJECT TO CONSENTS

RENT

Upon application.

RATES

We have been verbally informed by the Local Authority that the premises as existing are assessed for rating purposes as follows:

Rateable Value - £211,000

Rates Payable- £101,069 (*Interested parties are advised to make enquiries with the Local Authority*)

LEGAL COSTS

Each party to be responsible for their own legal and professional costs incurred in this transaction.

EPC

EPC To be provided.

CONTACT

For further information, please contact:

 **barkerproudlove**
retail property consultants
0113 388 4848
www.barkerproudlove.co.uk

MARK PROUDLOVE

07808 479310

mark@barkerproudlove.co.uk

GEORGE SCHOFIELD

07885 436 492

george@barkerproudlove.co.uk

JESS SWAIN

07885 127366

jess@barkerproudlove.co.uk



IMPORTANT NOTICE. Barker Proudlove give notice to anyone who may read these particulars as follows: 1. These particulars are prepared for the guidance only of prospective purchasers. They are intended to give a fair overall description of the property but are not intended to constitute part of an offer or contract. 2. Any information contained herein (whether in the text, plans or photographs) is given in good faith but should not be relied upon as being a statement or representation of fact. 3. Nothing in these particulars shall be deemed to be a statement that the property is in good condition or otherwise nor that any services or facilities are in good working order. 4. The photographs appearing in this brochure show only certain parts and aspects of the property at the time when the photographs were taken. Certain aspects may have changed since the photographs were taken and it should not be assumed that the property remains precisely as displayed in the photographs. Furthermore no assumptions should be made in respect of parts of the property which are not shown in the photographs. 5. Any areas, measurements or distances referred to herein are approximate only. 6. Where there is reference in these particulars to the fact that alterations have been carried out or that a particular use is made of any part of the property this is not intended to be a statement that any necessary planning, building regulations or other consents have been obtained and these matters must be verified by any intending purchaser. 7. Descriptions of a property are inevitably subjective and the descriptions contained herein are used in good faith as an opinion and not by way of statement of fact. Published February 2020.

 **BLAZE** 0161 387 7252